

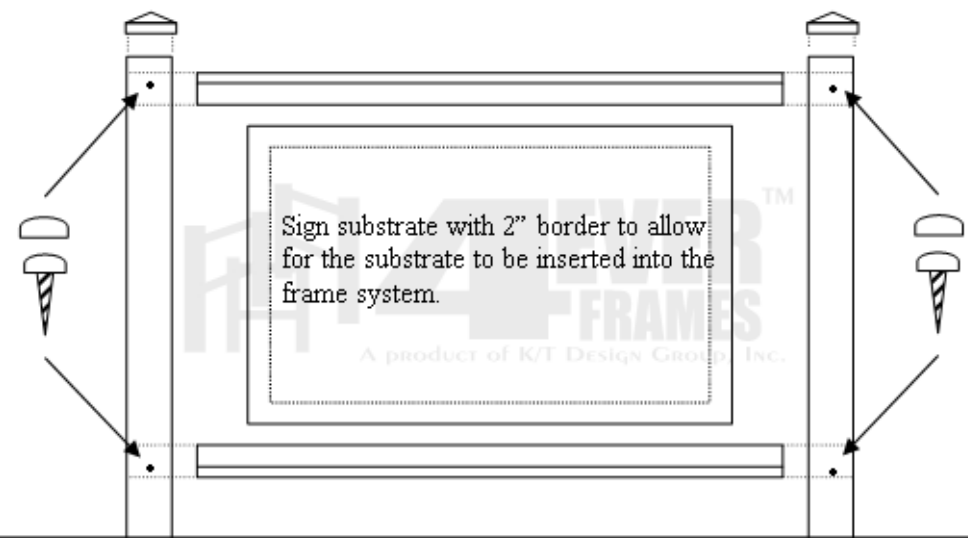

Thank you for your purchase of a 4EVER FRAMES product. It is our goal to provide you with a quality sign product that meets and exceeds industry standards. Your frame comes fabricated to fit the substrate that you are using and can be assembled in just a few minutes. **BE SURE TO CHECK YOUR PARTS LIST AND FOLLOW THE ASSEMBLY INSTRUCTIONS.** If you have any questions or problems please feel free to call us at **678-817-5995**. **BE SURE TO READ ALL INSTRUCTIONS** before you begin.

## PARTS LIST

- 2 Posts
- 2 Horizontals
- 2 Aluminum Inserts
- 8 3/4" Stainless Screws
- 8 Vinyl Screw Caps
- 2 Caps



### STEP 1

Don't worry, this won't take long.

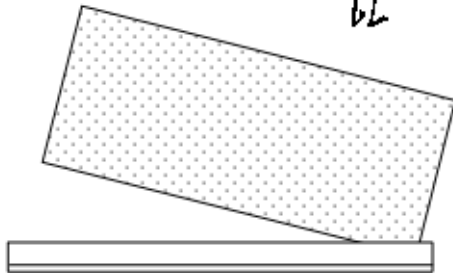

Insert your substrate as shown using a scissor motion.

### STEP 2

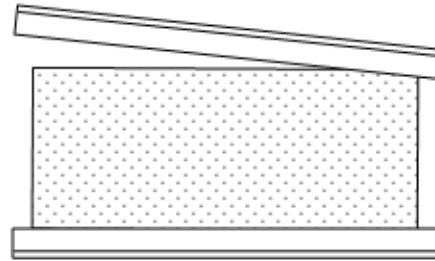

Place top horizontal onto substrate as pictured using the same scissor motion. Press down firmly to be sure sign is in each horizontal completely.

### STEP 3

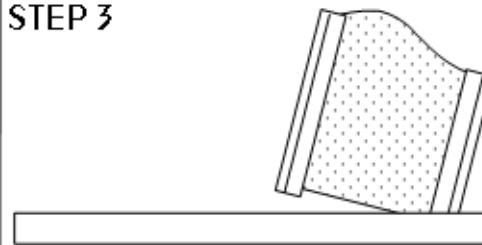

Place post on a table or ground. Use wood or box to avoid scratching frame. Put top horizontal in using a twisting motion then scissor the sign into the routed slot. Next put the bottom horizontal in by either twisting or tapping into routed hole.

### STEP 4

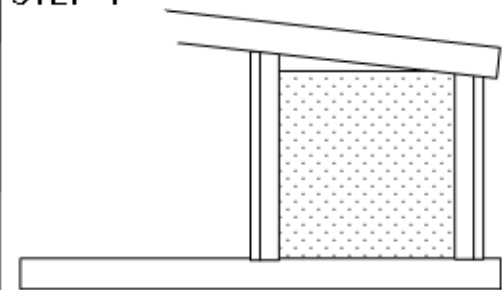

Next put the other post on using the same methods. Start at the top of the frame as illustrated.

### STEP 5

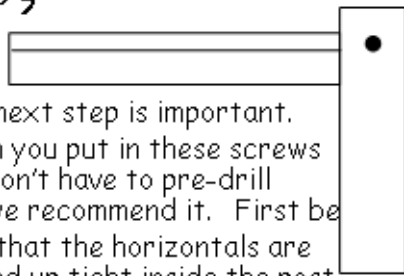

This next step is important. When you put in these screws you don't have to pre-drill but we recommend it. First be sure that the horizontals are pushed up tight inside the post so that they butt against the inner wall. Be sure the frame is square. Now as you put in the screws be sure to center them on the post and put them in at the widest part of the horizontal as illustrated.

### STEP 6

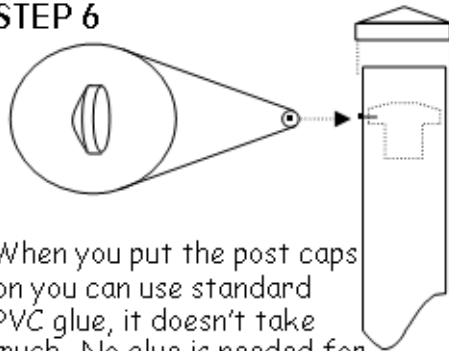

When you put the post caps on you can use standard PVC glue, it doesn't take much. No glue is needed for the screw caps, just snap them into place. If you are installing this sign you may want to wait till you are complete before putting on the caps

### STEP 7

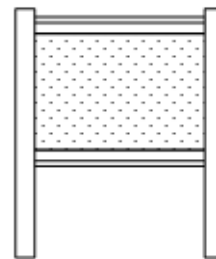

In just a few minutes you have completed your frame assembly!



## TIPS

- The box your frame came in is good to use to use a padding while you assemble your frame so it doesn't get dirty or scratched.
- A standard window cleaner works well but any non-abrasive cleaner is ok.
- If you are looking for a fast and simple installation method you should look into our no-dig system using our GROUNDbreaker™ stake.